

ICYITONDERWA: Iyi nyandiko yakozwe ku buryo bw'ikoranabuhanga n'Irembo. Mu rwego rwo kwirinda uburiganya, genzura niba iyi nyandiko ari iy'ukuri ushakisha numero ya dosiye **B251013172353TXQG** ku IremboGov mbere yo kuyikoresha.

URWEGO RW'UMUBITSI W'IMPAPUROMPAMO Z'UBUTAKA



UPI: 5/06/04/01/3349

AMASEZERANO Y' UBUKODE BURAMBYE No. 3349/NGO/KAZ

HAKURIKIJWE Itegeko Ngenga N° 08/2005 rigena imikoreshereze n'imirungire y'Ubutaka mu Rwanda n'Iteka rya Minisitiri N° 001/2008 ryo kuwa 01/04/2008 rigena ibyubahirizwa n'ibikorikizwa mu gukodesha ubutaka

HAGATI YA Repubulika y'u Rwanda, ihagarariwe n'Umubitsi w'Impapururompamo (ari we wiswe Umukode mu ngingo zikurikira) ku ruhande rumwe:

NA: umuntu cyangwa abantu bakurikira (Wiswe cyangwa biswe Ukodesha mu ngingo zikurikira) ku rundi ruhande:

Amazina y'Ukodesha cyangwa y'Abakodesha	Nomero z'ibibaranga	Imigabane
1. NYIRANSABIMANA CLOTILDE	1193870013002011	100%
2.		
3.		
4.		
5.		
6.		
7.		
8.		

Aderesi bahisemo kubarizwaho:

Ubahagarariye: NYIRANSABIMANA CLOTILDE
 Igihugu: RWANDA
 Intara: Eastern
 Akarere: NGOMA

Umurenge: Kazo
 Akagali: Birenga
 Umudugudu: Murindwa

BUMVIKANYE IBI BIKURIKIRA:

Ingingo ya 1:

Ibyerekeye uburenganzira bw'ubukode burambye

Umukode ahaye Ukodesha uburenganzira bw'ubukode bw'igihe cy'imyaka 99 ku butaka burangwa n'ibi bikurikira:

Intara: EASTERN
 Akarere: NGOMA
 Umurenge: KAZO
 Akagali: BIRENGA
 Umudugudu: MURINDWA

Nomero y'ikibanza: 3349
 Ubuso: 1,045sqm
 Igihe buzatangirira: 11-Sep-2012
 Igihe buzarangirira: 11-Sep-2111
 icyo ubutaka bugenewe gukoreshwa : Ubuhinzi (Ubutaka bw'abantu ku giti cyabo)

REPUBULIKA Y'U RWANDA



Icyemezo cy'iyandikisha ry'ubukode bw'igihe kirekire

UPI:

Iteka rya Minisitiri NO. 002/2008 ryose kuwa 01/04/2008 rigena uburyo ryandikishwa ry'ubutaka rikorwa, ingingo za 15 & 16

573015-500000

A. IGICE KIGENewe IBIRANGA UBUTAKA

A. IGICE KIGENewe IBIRANGA UBUTAKA					
Intara: EASTERN	Akarene: NCOMA	Umurenge: KATZ	Akagari: BIRENGA	Umudugudu: GUTINGA	
Numero y'iyandikisha: 0349 NGOMBAZ		Ubusobanuro/Icyo ubutaka bugenewe gukoreshewa:		Numero y'ikarita yometse: 034900	
Itariki y'iyandikisha rya mbere:		Ubutwari/Umubiri w'abapanga ku giti cyatwo		Numero ya pariseli: 0349 0000	
Numero y'inyandiko	Itariki	Numero y'icyemezo	Ubwoko bw'inyungu ubutaka bufitse ku bundi	Ibiranga inyungu ubutaka bufitse ku bundi	Umukono na kashe by'Umubiri wungirije w'impapururampamo z'ubutaka

ANNEX to Certificate of Registration of Emphyteutic Lease Title Page 3 of 3

EXTRACT CADASTRAL PLAN 3349C

UPI: 5/06/04/01/3349

PROVINCE:	EASTERN	DISTRICT:	NGOMA	SECTOR:	KAZO	CELL:	BIRENGA
-----------	---------	-----------	-------	---------	------	-------	---------

MAP OF PARCEL

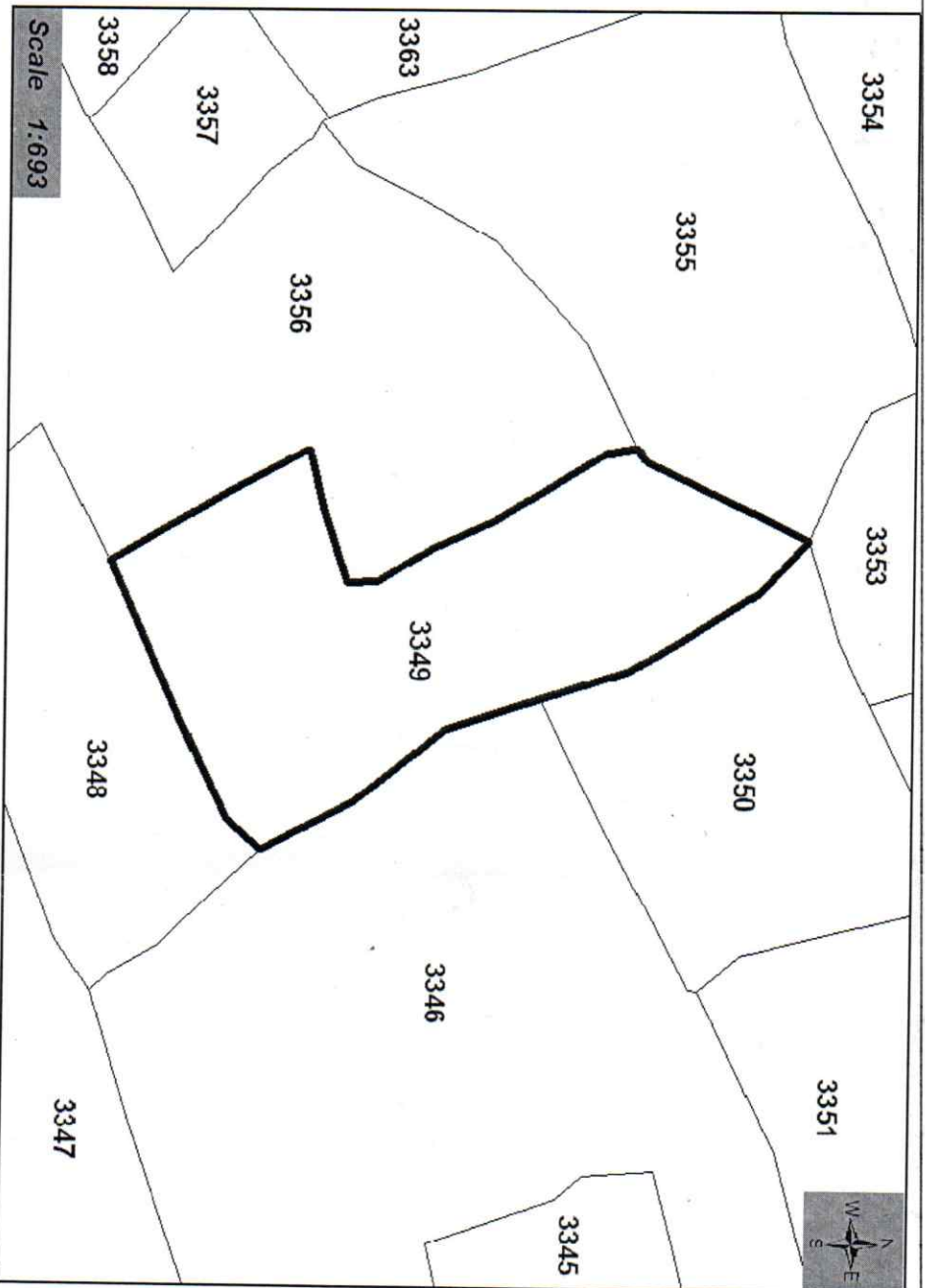

Note
Parcel Map prepared based
on General Boundaries Principle

Date:	10-Sep-2012	MUKUNZI A EMMANUEL	DEPUTY REGISTRAR	Signature
-------	-------------	--------------------	------------------	-----------

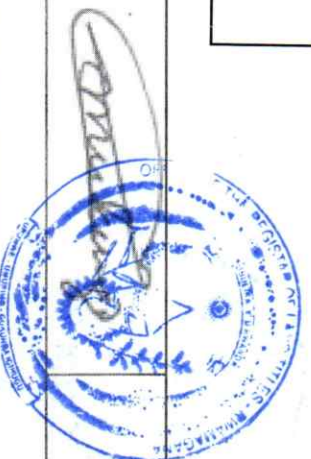



REPUBLIC OF RWANDA



DEED PLAN

			PARCEL LOCATION	
PARCEL OWNER(S)	NYIRANSABIMANA CLOTILDE		DISTRICT	NGOMA
UPI	5/06/04/01/3349		SECTOR	KAZO
PLANNED LAND USE/ZONING	A1-Agriculture zone		CELL	BIRENGA
PLOT DEVELOPED: YES/NO ?			VILLAGE	MURINDWA
DEED PLAN No:	Area = 548.35 Sqm		SURVEY DATE	10/10/2025

Flat No	
Floor No	
Floor Area	
Total Floor Area (Sqm)	

Boundary Details

Condominium Survey

Unit No		Common Elements Area (Sqm)	
Unit Area (Sqm)		Total Building Area	
Unit Area Ratio (%)			

Beacon	Easting(m)	Northing(m)		From	to	Bearing	Dist(m)
6	554844.24	4755241.73		6	7	174° 17' 21"	2
7	554844.44	4755239.66		7	8	253° 42' 54"	12
8	554832.67	4755236.22		8	9	149° 53' 14"	20
9	554842.58	4755219.14		9	10	065° 19' 48"	25
10	554865.08	4755229.48		10	11	040° 49' 02"	4
11	554867.61	4755232.40		11	12	331° 23' 00"	9
12	554863.36	4755240.19		12	13	321° 48' 05"	3
13	554861.53	4755242.51		13	14	321° 48' 05"	7
14	554857.01	4755248.26		14	6	242° 56' 19"	14

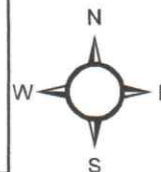
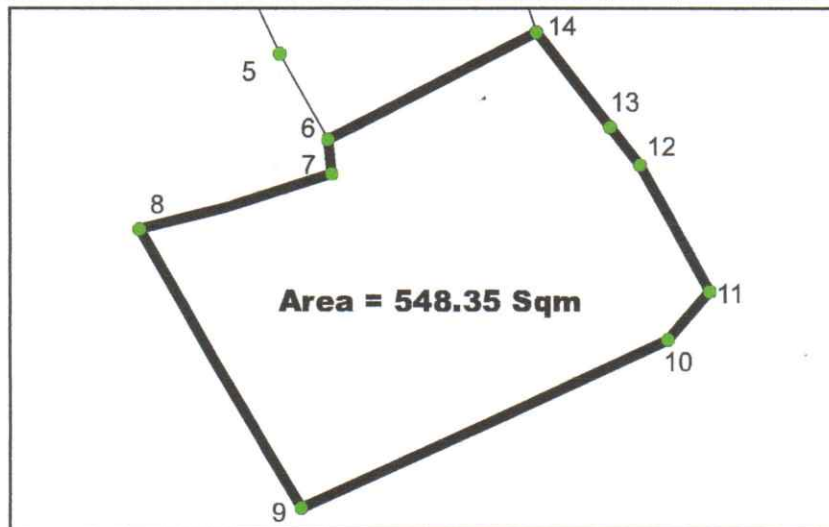

Projected Coordinate System: ITRF_2005
 Projection: Transverse Mercator
 False Easting: 500000.00000000
 False Northing: 5000000.00000000
 Central Meridian: 30.00000000
 Scale Factor: 0.99990000
 Latitude Of Origin: 0.00000000
 Linear Unit: Meter

SCALE: 1/427

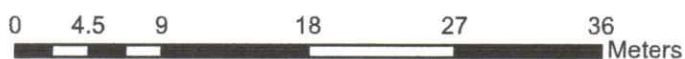

Legend

	BEACON
	PLOT 2
	PLOT

Surveyed by: NDAYAVUGWA Zachee

Signature:

Date & Stamp: 10/10/2025

Approved by: CMO/GIS and Land Surveyor

Name:

Post:

Date & Signature :



REPUBLIC OF RWANDA



DEED PLAN

PARCEL OWNER(S)	NYIRANSABIMANA CLOTILDE	PARCEL LOCATION	
UPI	5/06/04/01/3349	DISTRICT	NGOMA
PLANNED LAND USE/ZONING	A1-Agriculture zone	SECTOR	KAZO
PLOT DEVELOPED: YES/NO ?		CELL	BIRENGA
		VILLAGE	MURINDWA
DEED PLAN No:	Area = 495.88 Sqm	SURVEY DATE	10/10/2025

Flat No	
Floor No	
Floor Area	
Total Floor Area (Sqm)	

Boundary Details

Condomnium Survey

Unit No		Common Elements Area (Sqm)	
Unit Area (Sqm)		Total Building Area	
Unit Area Ratio (%)			

Beacon	Easting(m)	Northing(m)	From	to	Bearing	Dist(m)
1	554840.36	4755279.39	1	2	206° 07' 56"	16
2	554833.46	4755265.33	2	3	239° 51' 23"	1
3	554832.35	4755264.68	3	4	170° 53' 18"	3
4	554832.80	4755261.89	4	5	150° 28' 26"	17
5	554841.27	4755246.94	5	6	150° 18' 09"	6
6	554844.24	4755241.73	6	14	062° 56' 19"	14
14	554857.01	4755248.26	14	15	341° 25' 30"	9
15	554854.30	4755256.34	15	16	342° 18' 33"	8
16	554851.85	4755264.00	16	17	328° 03' 20"	13
17	554844.84	4755275.25	17	1	312° 45' 49"	6

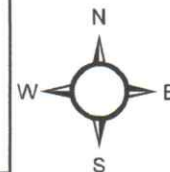
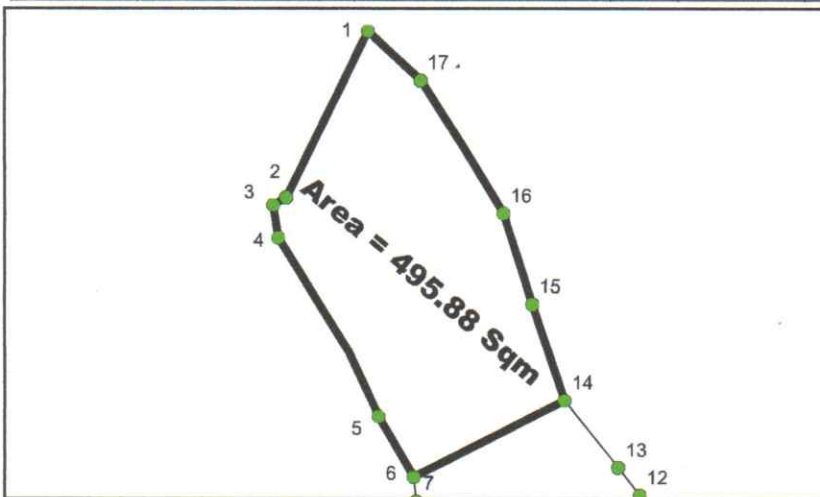

Projected Coordinate System: ITRF_2005
 Projection: Transverse Mercator
 False Easting: 500000.00000000
 False Northing: 5000000.00000000
 Central Meridian: 30.00000000
 Scale Factor: 0.99990000
 Latitude Of Origin: 0.00000000
 Linear Unit: Meter

SCALE: 1/588

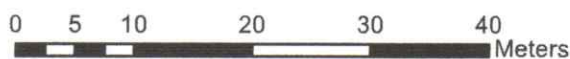

Legend

- BEACON
- PLOT 2
- PLOT

Surveyed by: NDAYAVUGWA Zachee

Signature:

(Signature)
 NDAYAVUGWA ZACHEE
 SURVEYOR
 REG. NO. 1500220
 TEL. 093122578

Date & Stamp: 10/10/2025

Approved by: CMO/GIS and Land Surveyor

Name:

Post:

Date & Signature :

RAPORO Y'IPIMWA RY'UBUTAKA

Kuwa... 10/10/2025

<p>1. AMAZINA YA BA NYIR'UBUTAKA NA ID:</p> <ul style="list-style-type: none"> • NYIRANSABIMANA Ch. T. I. de • 1193 87 0013 00 2011 • • 	<p>AHO UBUTAKA BUHEREREYE</p> <p>Akarere: ... Ngoma</p> <p>Umurenge: ... Kaza</p> <p>Akagali: ... Birenga</p> <p>Umudugudu: ... Muvu mukia</p>
<p>UPI: ... 516610410113349</p> <p>Ibikorwa biri ku butaka: ... F.N.ZU</p> <p>Ubuso bw'ubutaka : ... 1046 Sqm</p> <p>Igishushanyo cy'imiterere y'ikibanza/isambu n'imbibi zacyo</p>	<p>SERIVISI ISABWA ¹:</p> <ul style="list-style-type: none"> - Kugabanya ubutaka mo ibice <input checked="" type="checkbox"/> - Kubaruza ubutaka bwa mbere <input type="checkbox"/> - Gukosora imbibi/Ubuso <input type="checkbox"/> - Iyimirwa ku mpamvu z'inyungu rusange (expropriation) <input type="checkbox"/> - icyangombwa cy'ubwubatsi (Auto-batir) <input type="checkbox"/> - Isangiramatungo ku nyubako <input type="checkbox"/>

¹ Hitamo ikigiye gukorwa; si ngombwa ko serivisi iba imwe

UBURYO IBIPIMO BYAFASHWEMO²

- Ibikoreshe byakoreshejwe:
 - Ubwoko bwa GNSS rover: *UNI strong*
 - Serial No: *G97A24A24 20036*
 - RwandaGeonet User-ID: *RNRA-19*
 - Surveyor Code number: *L500220*
- Uburyo bwakoreshejwe mu kwakira ibipimo biva kuri CORS:
 - Network ☒
 - Single Base ☐ Mountpoint Name: *I max*
- Accuracy yakoreshejwe (cm): *0.007* cm
- Italiki ipimwa ryakoreweho (Umwaka-Ukwezi-Itariki): *10-10-2025*
- Gupima byatangiyeye saa *12h40* birangira saa *1h10*
- Imbogamizi zaba zarabaye ziturutse ku bikoreshe byakoreshejwe mu gihe cyo gupima ubutaka:

*Nta***UMUBARE W'IBIBANZA BYAVUYEMO IYO ARI UKUGABANYAMO IBICE : *2***

Ibibanza	Ubuso	Ibibanza	Ubuso
1	<i>548.35</i>	8	
2	<i>495.88</i>	9	
3		10	
4		11	
5		12	
6		13	
7		14	

Icyitonderwa: Mu gihe ibibanza birenga umubare uri muri iyi mbonerahamwe shyiraho umugereka

IMYIRONDO RO YA BA NYIR'UBUTAKA BUHANA IMBIBI N'UBUTAKA BWAPIMWE:

UPI	Amazina	Telepho ne	Yagizweho ingaruka (Yego/Oya)	Umukono
<i>3350</i>	<i>BUOVEDUSENGA</i>		<i>OYA</i>	<i>[Signature]</i>
	<i>Ehmanu</i>			
<i>3348</i>	<i>NKUNBWEZA</i>		<i>OYA</i>	<i>[Signature]</i>
	<i>LANDOARO</i>			
<i>3356</i>	<i>SIBANIRO</i>		<i>OYA</i>	<i>[Signature]</i>
	<i>Zwin De Rive</i>			

Icyitonderwa:

1. Mu gihe ba nyir'imbibi barenga umubare uri muri iyi mbonerahamwe shyiraho umugereka.
2. Mu gihe umwe mu bagizweho ingaruka n'ipimwa ry'ubutaka atabashije kuboneka, Komite y'ubutaka y'Akagari ibikorera raporo ikemezwa n'umunyamabanga Nshingwabikorwa w'Akagari.

KWEMEZA GUKOSORA IMBIBI (Aha hashyirwaho umukono gusa n'abagizweho ingaruka n'ikosora)

Twebwe abagizweho ingaruka n'ikosora ry'ubuso/imbibi z'ubutaka bufite UPI/.../...../.../....

Dushingiye ku kuba Bwana/Madamu yapimishije ubutaka bwe duhana imbibi duhari, akaba ataturengereye. Dutanze uburenganzira bwo gukosora imbibi muri rejisitiri y'ubutaka nk'uko bwapimwe.

Amazina

1.
2.
3.
4.
5.

Umukono

1.
2.
3.
4.
5.

ABAGIZWEHO INGARUKA N'IKOSORA BATAGARUYE IBYANGOMBWA

S/N	AMAZINA	UPI	IMPAMVU	Izina rya Bank (mu gihe kiri mu ngwate)
1				
2				
3				
4				
5				

NYIRI UBUTAKA

Amazina : *NYIRANSABIMANA Clotilde*

Umukono :

Telephone : *0785751336 / 0784105014 / 0783427796.*

UWAPIMYE UBUTAKA

Njyewe .. *NDAYAYU GUYA Zachée*

Impuguke mu gufata ibipimo ku butaka, ndemeza ko ibipimo byafashwe hakurikijwe amahame y'umwuga wo gupima ubutaka. Ndemeza kandi ko abagizweho ingaruka n'iri pimwa bagaragara mu mbonerahamwe iri haruguru aribo bashyize umukono kuri iyi raporo.

Mu gihe hagaragaye ko ibipimo n'amakuru natanze birimo amakosa, ngomba kubikosora nta kiguzi cyiyongereyeho.

Amazina : *NDAYAYU GUYA Zachée*

Umukono na Kashe :

Telephone : *0783122579*